

WEST SIDE ALTERNATIVES from County Road 507

1 Do Nothing - this alternative includes using the existing western points of access to the park.

2 New Road to Bottle Lake - this alternative includes building a new road that connects County Road 507 to the western shore of Bottle Lake on Crown Land, north of Catchacoma Lake.

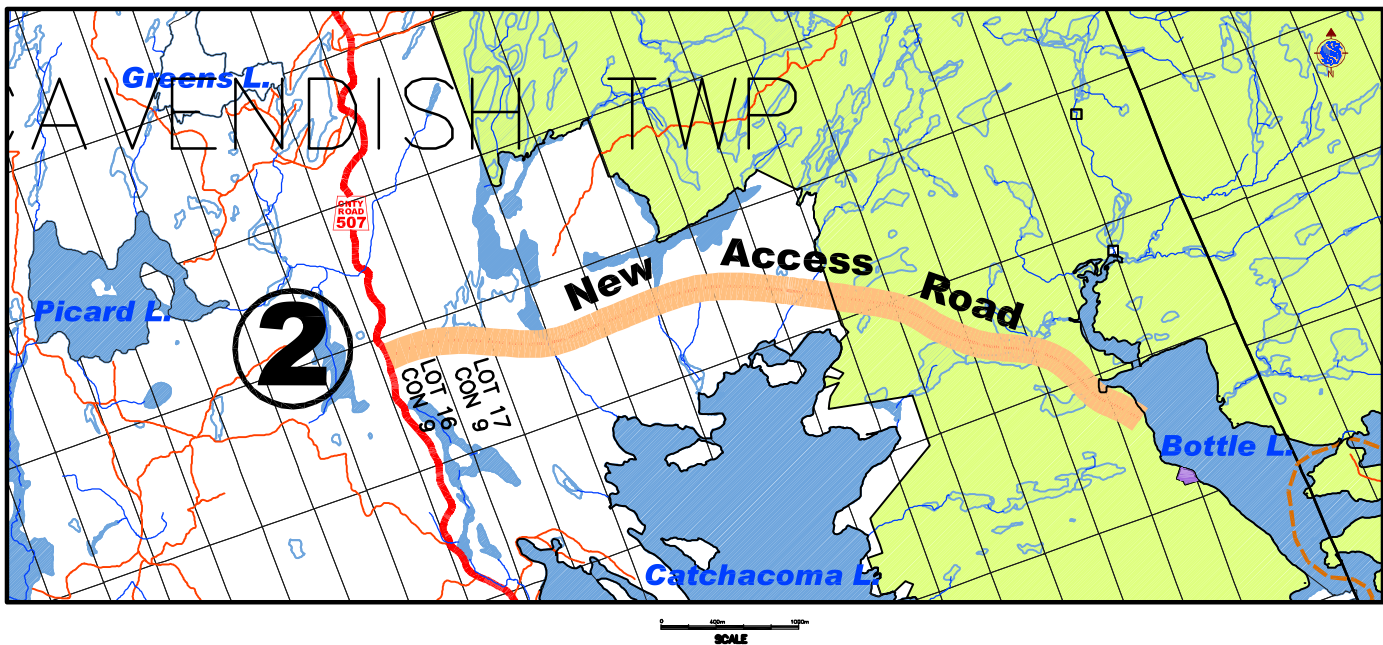

3 Beaver Lake Road - this alternative includes improving Beaver Lake Road and extending it a short distance to provide access to Sucker Lake, Bottle Lake or Beaver Lake.

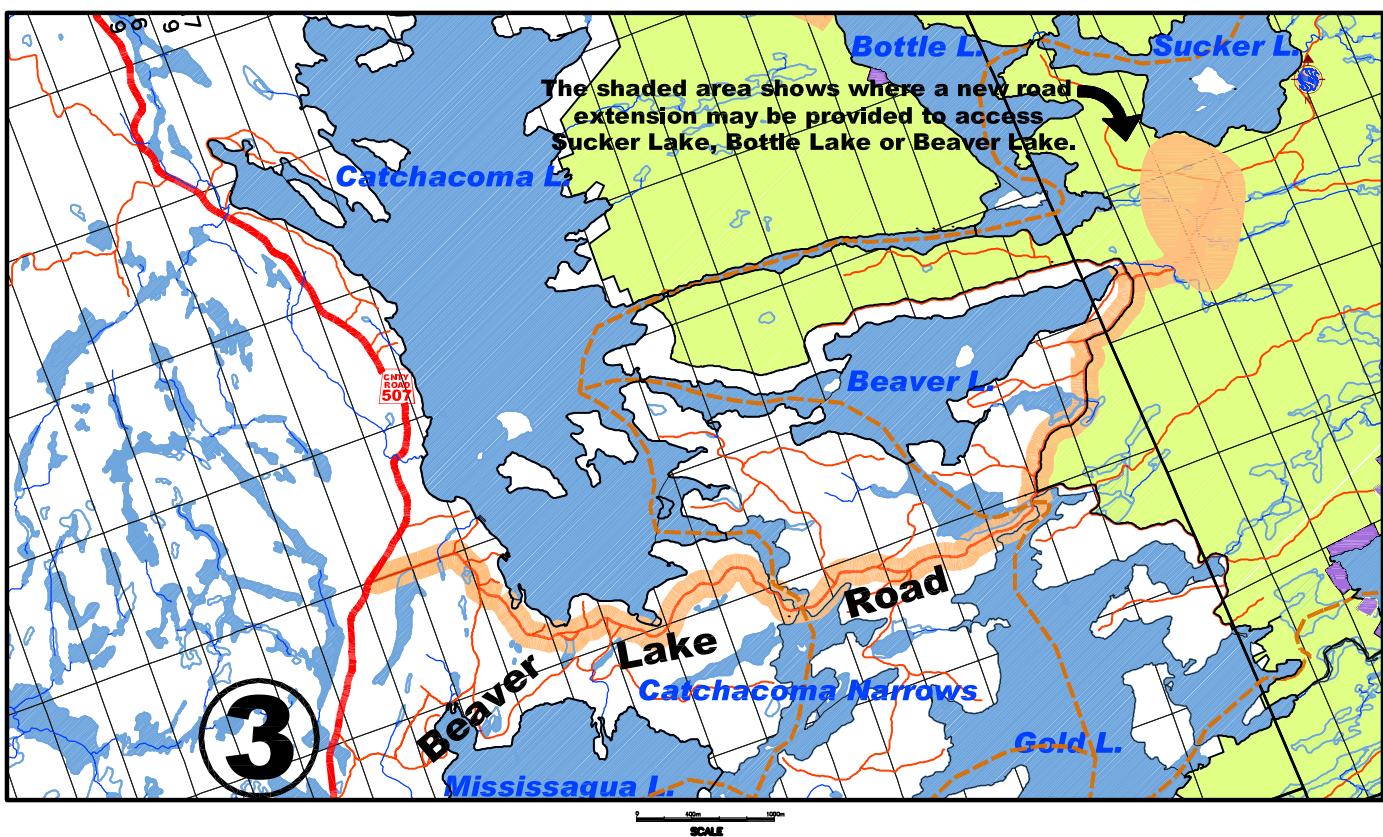

4 Mississagua Lake Dam Road - this alternative includes upgrading Mississagua Lake Dam Road and extending the road to the southern shore of Mississagua Lake.

